

HEX HEAD TAPCON OR OTHER WALL MOUNTED CONCRETE SCREW - BY OTHERS  
NOTE: DO NOT OVER-TIGHTEN OR CRUSH PANEL  
USE WASHER IF HEX HEAD IS SMALLER THAN GROMMET HOLE Ø

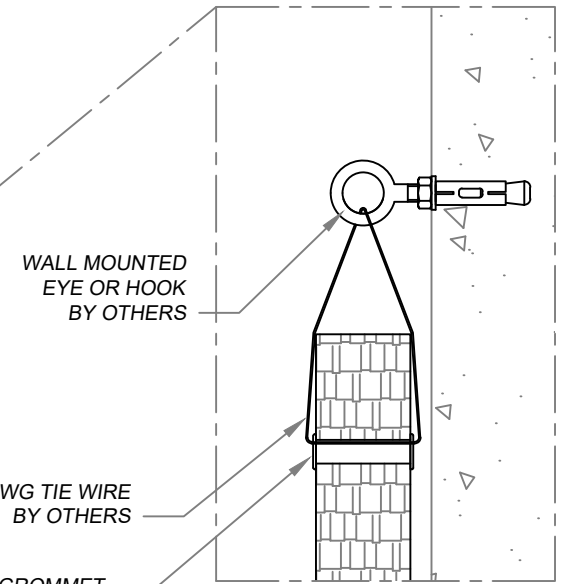
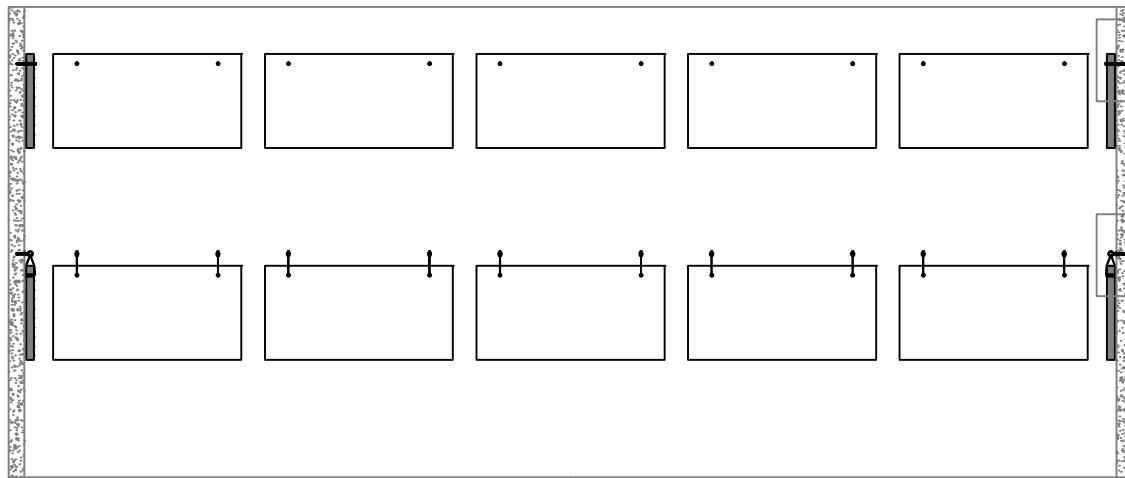
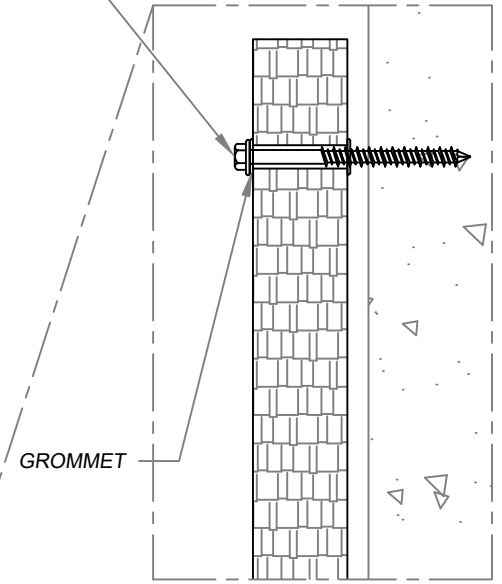
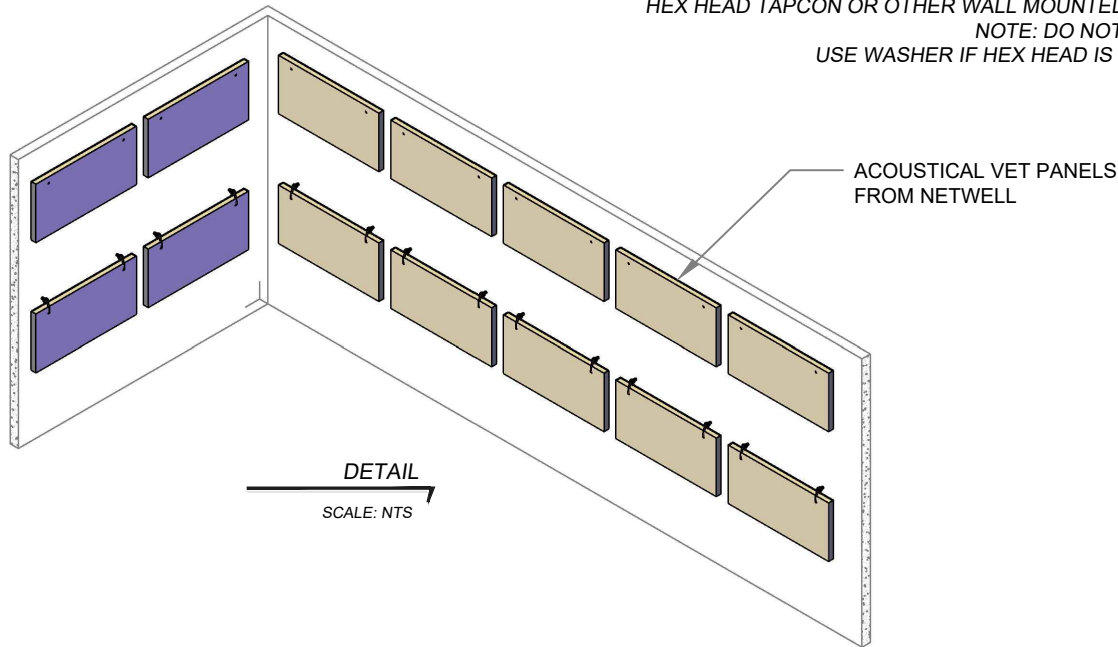

**INSTALLATION METHOD 5**  
ACOUSTICAL VET PANELS CAN BE MOUNTED TO WALLS,  
EITHER DIRECTLY (PER TOP ROW) OR BELOW A WALL  
MOUNTED EYEBOLT OR HOOK (PER BOTTOM ROW)